



11 Sandringham Road, Derby, DE21 4EY
£149,950

ENTRANCE HALL

Stairs to first floor, access to all rooms

LIVING ROOM 14'5" x 11'5" (4.4 x 3.5)

Double glazed window, laminate flooring

KITCHEN DINING ROOM 13'1" x 9'6" (4.0 x 2.9)

Re fitted kitchen dining room with double glazed doors and windows to rear gardens

UTILITY ROOM

Utility area

FIRST FLOOR LANDING

Loft Access, carpet flooring

BEDROOM 14'5" x 9'6" (4.4 x 2.9)

Double glazed window, carpet flooring

BEDROOM 11'1" x 9'2" (3.4 x 2.8)

Double glazed window, carpet flooring

BATHROOM

Matching white bathroom suite with tiled surrounds

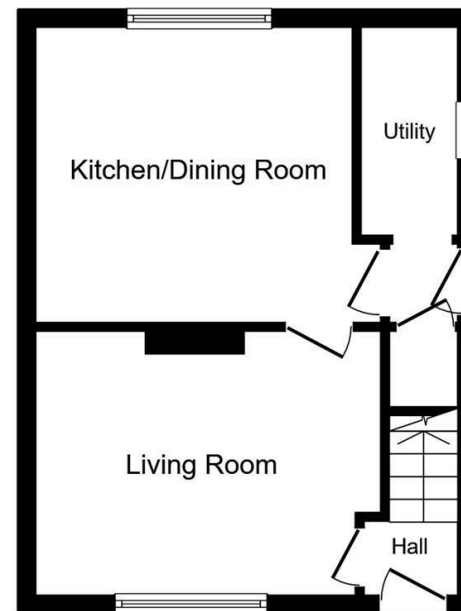

Ground Floor

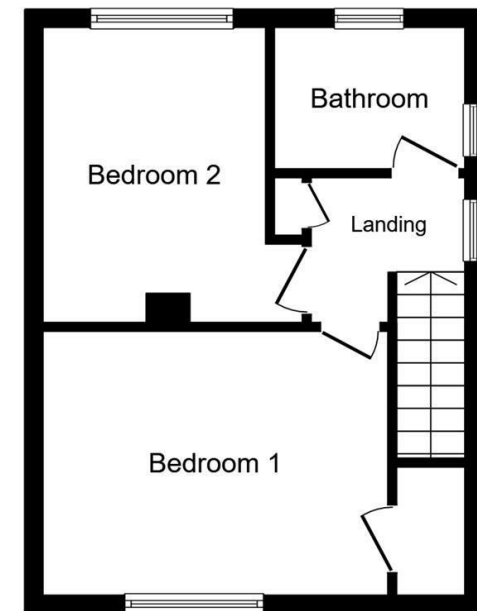

First Floor